



**DOWNING
THORPE
JAMES**

ARCHITECTURE
PLANNING
LANDSCAPE ARCHITECTURE
ENGINEERING
1881 Ninth Street, Suite 103
Boulder, Colorado 80302
303-443-7533

HIGHLANDS RANCH
GOLF CLUB

LEGEND

- PROPOSED CONTOURS (10.1) (TYP)
- PROPOSED CONTOURS (50.1) (TYP)
- EXISTING CONTOURS (10.1) (TYP)
- EXISTING CONTOURS (50.1) (TYP)
- - - - - R.O.M. LINE
- ==== MASONRY WALLS
- ===== PROPOSED 8' W. CONCRETE CART PATH (6A D-3)
- ===== PROPOSED 5' W. CONCRETE SIDEWALK (6B D-3)
- LIMIT OF WORK LINE
- METAL FENCE (1 D-4)
- LARGE PILASTER (2 D-4)
- SMALL PILASTER (1 D-4)
- ⊗ LIGHT BOLLARD (3' HT.) (4A D-3)
- ⊗ LIGHT BOLLARD (4' HT.) (4B D-3)
- ⊗ STONE VENEER MASONRY BASE (4 D-4)
- (DOUBLE-ARM STREET LIGHT BY OTHERS)
- NODE LOCATION
- ▲ DRILLED PIER LOCATION

- BOC BEGINNING OF CURVE
- RAD RADIUS VERTEX
- PRC POINT OF REVERSE CURVE
- POT POINT OF TANGENCY
- EOT END OF TANGENT
- BOT BEGINNING OF TANGENT
- EOC END OF CURVE

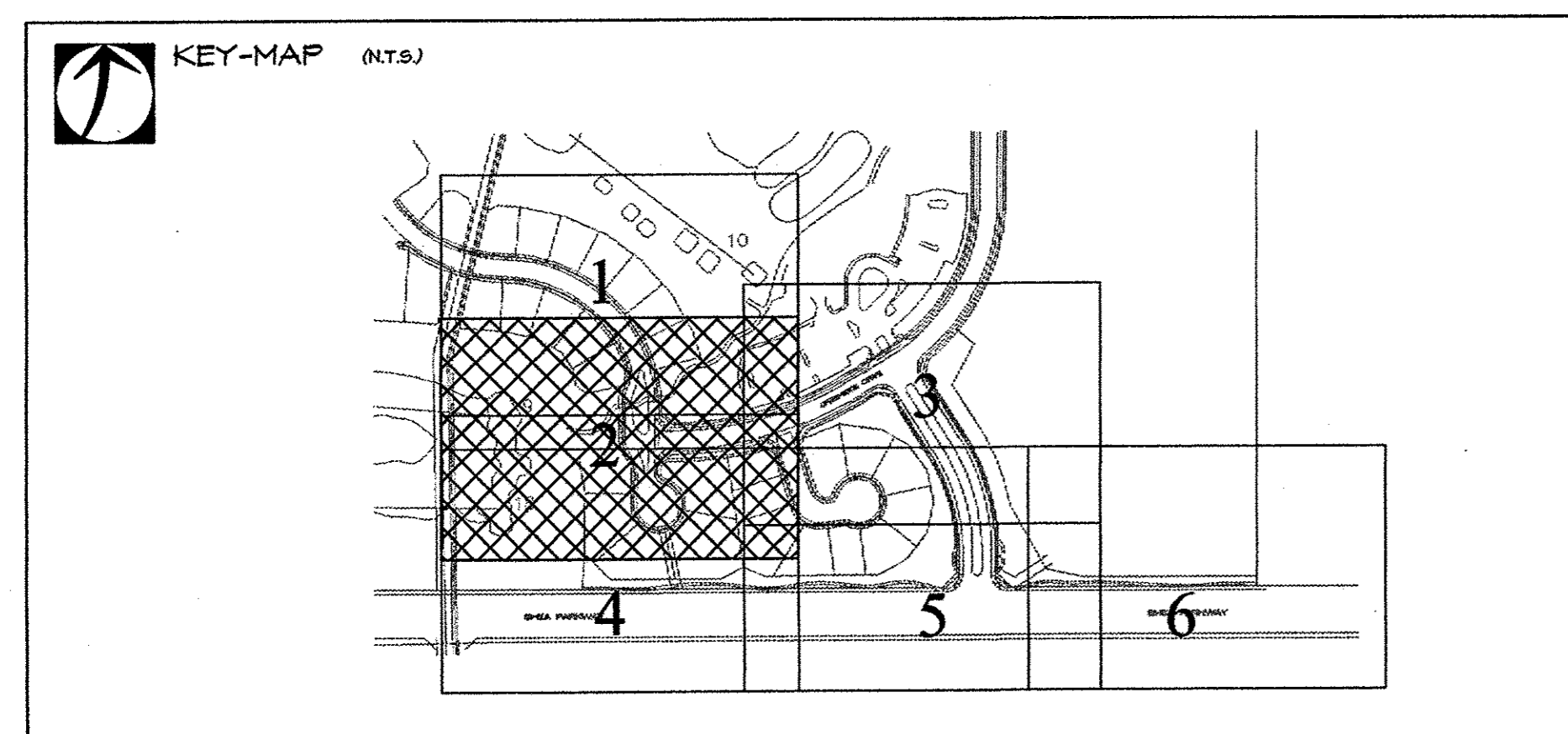
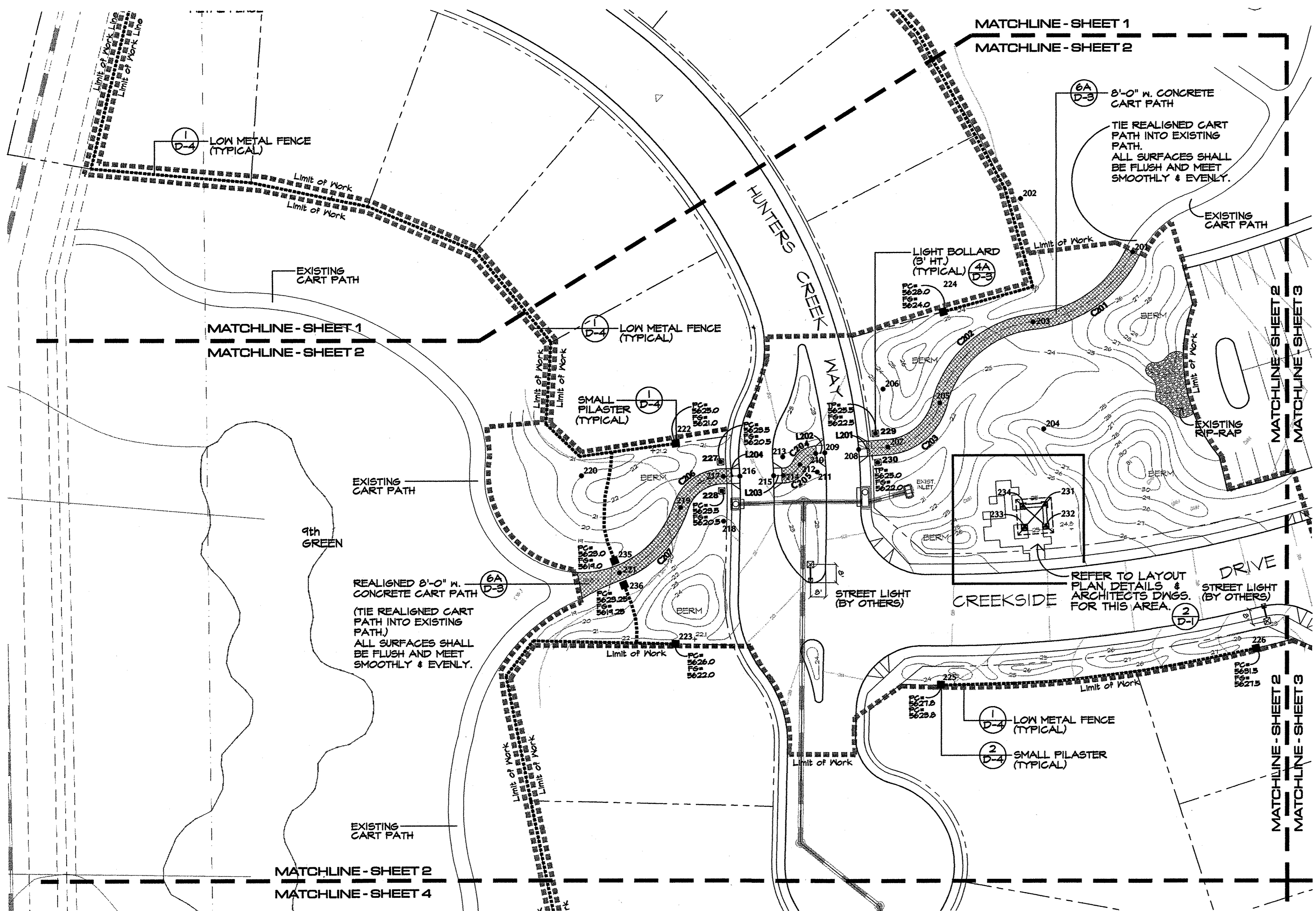

WALK CENTERLINE NODE INFORMATION

Node #	Northing	Easting	Description
201	626547.15	136750.80	BOC
202	626575.88	136691.39	RAD
203	626510.20	136697.84	PRC
204	626453.47	136703.42	RAD
205	626467.44	136648.16	PRC
206	626475.04	136618.10	RAD
207	626444.13	136620.55	POT
208	626442.91	136605.09	EOT
209	626441.14	136587.15	BOT
210	626440.74	136582.25	POT
211	626430.78	136583.05	RAD
212	626434.83	136573.91	PRC
213	626438.89	136564.77	RAD
214	626428.89	136565.05	POT
215	626428.74	136559.87	EOT
216	626428.40	136541.91	BOT
217	626428.35	136533.13	POT
218	626404.35	136533.27	RAD
219	626411.73	136510.44	PRC
220	626428.75	136487.76	RAD
221	626377.17	136477.88	EOC
222	626464.97	136510.84	S.PILASTER
223	626339.31	136507.69	S.PILASTER
224	626515.64	136650.16	S.PILASTER
225	626317.40	136648.61	S.PILASTER

WALK CENTERLINE TANGENT INFORMATION

NUMBER	DIRECTION	DISTANCE
L201	N 85°28'47" E	15.50'
L202	S 85°24'32" W	4.91'
L203	S 88°15'34" W	5.21'
L204	S 89°40'12" W	10.21'

WALK CENTERLINE CURVE INFORMATION

NUMBER	RADIUS
C201	66.00
C202	57.33
C203	31.00
C204	10.00
C205	10.00
C206	24.00
C207	55.33

PIER INFORMATION

Node #	Northing	Easting	Description
231	626412.92	136703.74	DRILLPIER
232	626401.61	136704.49	DRILLPIER
233	626400.87	136693.17	DRILLPIER
234	626412.17	136692.44	DRILLPIER

BID DOCUMENTS

CALL UNCC
TWO WORKING DAYS
BEFORE YOU DIG
1-800-922-1987
534-6700 METRO DENVER AREA
UTILITY NOTIFICATION CENTER OF COLORADO

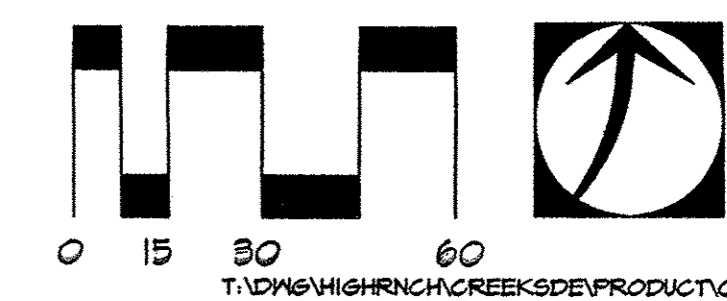

SCALE: 1"=30'
DRAWN BY: PS
CHECKED BY: MAB
PROJECT NUMBER: 97098.41
ISSUE DATE: April 21, 1998
REVISIONS: June 4, 1998
July 24, 1998
August 26, 1998
SHEET TITLE: LAYOUT PLAN
SHEET NUMBER: LG - 2