

LEGEND

- 15 → PROPOSED CONTOURS (10:1) (TYP)
- 10 → PROPOSED CONTOURS (5:1) (TYP)
- 15 → EXISTING CONTOURS (10:1) (TYP)
- 10 → EXISTING CONTOURS (5:1) (TYP)
- R.O.W. LINE
- ==== MASONRY WALLS
- ==== PROPOSED 8' W. CONCRETE CART PATH (6A D-3)
- ==== PROPOSED 5' W. CONCRETE SIDEWALK (6B D-3)
- LIMIT OF WORK LINE
- METAL FENCE (1 D-4)
- LARGE PILASTER (2 D-4)
- SMALL PILASTER (1 D-4)
- ⊗ LIGHT BOLLARD (8' HT.) (4A D-3)
- ⊗ LIGHT BOLLARD (4' HT.) (4B D-3)
- ⊗ STONE VENEER MASONRY BASE (4 D-4)
- ⊗ (DOUBLE-ARM STREET LIGHT BY OTHERS)
- 217 NODE LOCATION

ADD/ALTERNATE

- 227 DRILLED PIER LOCATION

NODE INFORMATION

Node #	Northing	Easting	Description
401	626125.55	136456.15	L.PILASTER
402	626070.10	136513.26	L.PILASTER
403	626069.90	136633.32	L.PILASTER
404	626069.91	136783.05	L.PILASTER

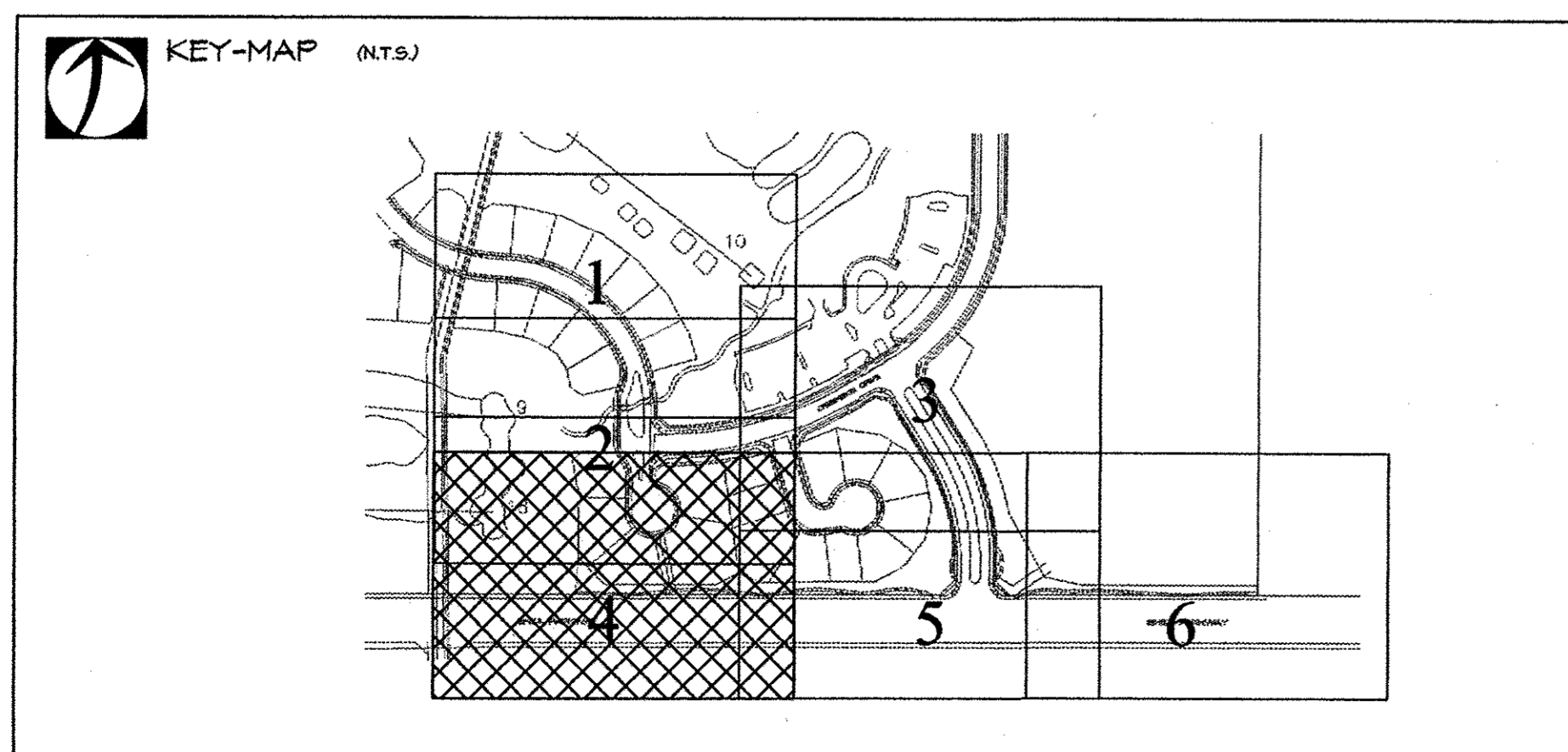

DOWNING THORPE JAMES

ARCHITECTURE
PLANNING
LANDSCAPE ARCHITECTURE
ENGINEERING
1881 Ninth Street, Suite 103
Boulder, Colorado 80302
303-443-7533

HIGHLANDS RANCH
GOLF CLUB

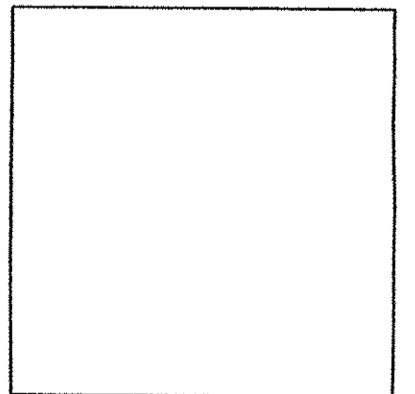

SCALE: 1"=30'
DRAWN BY: PS
CHECKED BY: MAB
PROJECT NUMBER: 97098.41
ISSUE DATE: April 21, 1998
REVISIONS:
June 4, 1998
July 24, 1998
August 26, 1998

CALL UNCC
TWO WORKING DAYS
BEFORE YOU DIG
1-800-922-1987
534-6700 METRO DENVER AREA
UTILITY NOTIFICATION CENTER OF COLORADO

SHEET TITLE:
LAYOUT PLAN
SHEET NUMBER:

BID DOCUMENTS

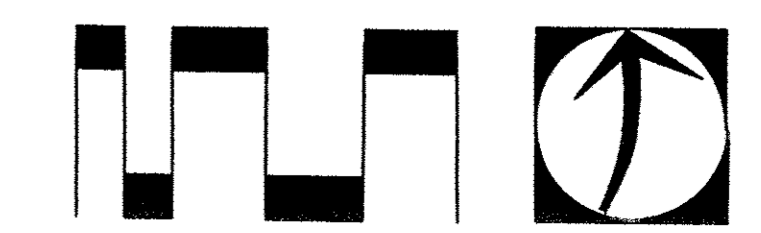

LG - 4